

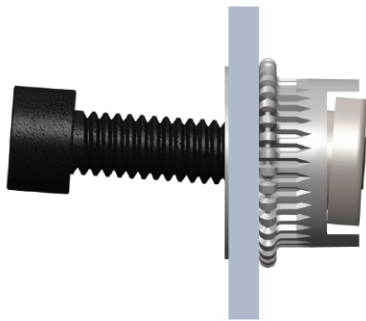

# RIV-FLOAT® - SHORT

Floating internal threads allow for component attachments in off center applications

The NEW Low-Profile addition to the RIV-FLOAT® family

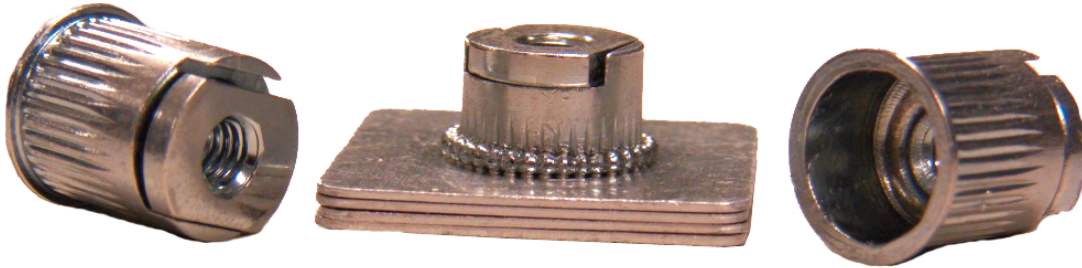

RIV-FLOAT® - SHORT Installed

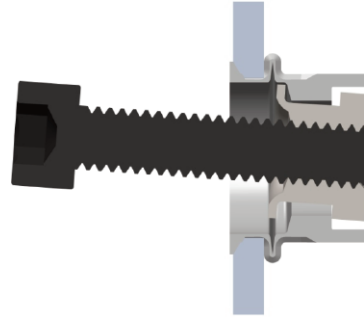

CROSS SECTION OF RIV-FLOAT® - SHORT Installed

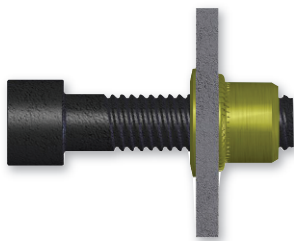

Standard Rivet Nut Installed

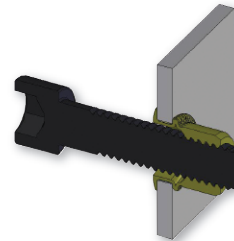

Cross Section of a Standard Rivet Nut Installed

Sherex rivet nuts are compatible with the following hardware:  
**GRADE 2, GRADE 5, CLASS 8.8 and CLASS 9.8**  
Please contact Sherex when using other grade fasteners.



**RIV-FLOAT® - SHORT is installed with Flex-5 Hydro-Pneumatic tool with RIV-FLOAT® - SHORT Anvil**



**Ensure easy, accurate, and fast attachment of components in off center applications.**

**Features and Benefits of RIV-FLOAT® - SHORT**

- **ACCOUNTS FOR TOLERANCE STACK UP IN JOINT DESIGN AND MISALIGNMENT DURING SERVICE OF THE JOINT**
- **NEW LOW-PROFILE DESIGN PROVIDES GREATER BACKSIDE CLEARANCE**
- **ALLOWS INSTALLATION POST FINISH IN APPLICATIONS WHERE WELD NUTS OR CAGE NUTS ARE TYPICALLY USED**
- **0.020" RADIAL FLOAT**
- **ROHS COMPLIANT**

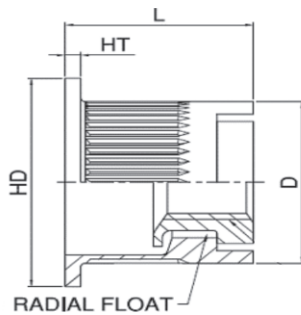

Uninstalled

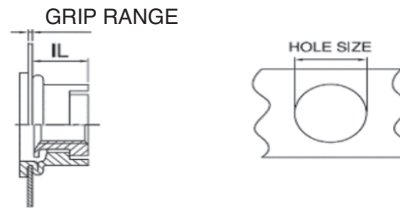

Installed

**RFSK SERIES - SMALL FLANGE**

| SHEREX Part Number<br>Inch - Steel   | Thread Size | Radial Float | Grip Range |      | L     | HD    | HT   | D     | IL   | Hole Size |
|--------------------------------------|-------------|--------------|------------|------|-------|-------|------|-------|------|-----------|
|                                      |             |              | Min.       | Max. |       |       |      |       |      |           |
| RFSK2-0832-130                       | 8-32 UNC    | 0.020        | .020       | .130 | .394  | .480  | .025 | .431  | .246 | .433      |
| RFSK2-1024-130                       | 10-24 UNC   | 0.020        | .020       | .130 | .394  | .480  | .025 | .431  | .246 | .433      |
| RFSK2-1032-130                       | 10-32 UNF   | 0.020        | .020       | .130 | .394  | .480  | .025 | .431  | .246 | .433      |
|                                      |             |              |            |      |       |       |      |       |      |           |
| SHEREX Part Number<br>Metric - Steel | Thread Size | Radial Float | Grip Range |      | L     | HD    | HT   | D     | IL   | Hole Size |
|                                      |             |              | Min.       | Max. |       |       |      |       |      |           |
| RFSK2-470-3.3                        | M4x0.7 ISO  | 0.50         | 0.5        | 3.3  | 10.00 | 12.20 | .63  | 10.95 | 6.25 | 11.00     |
| RFSK2-580-3.3                        | M5x0.8 ISO  | 0.50         | 0.5        | 3.3  | 10.00 | 12.20 | .63  | 10.95 | 6.25 | 11.00     |

**RFSL SERIES - LARGE FLANGE**

| SHEREX Part Number<br>Inch - Steel   | Thread Size | Radial Float | Grip Range |      | L     | HD    | HT   | D     | IL   | Hole Size |
|--------------------------------------|-------------|--------------|------------|------|-------|-------|------|-------|------|-----------|
|                                      |             |              | Min.       | Max. |       |       |      |       |      |           |
| RFSL2-0832-130                       | 8-32 UNC    | 0.020        | .020       | .130 | .406  | .555  | .033 | .431  | .246 | .433      |
| RFSL2-1024-130                       | 10-24 UNC   | 0.020        | .020       | .130 | .406  | .555  | .033 | .431  | .246 | .433      |
| RFSL2-1032-130                       | 10-32 UNF   | 0.020        | .020       | .130 | .406  | .555  | .033 | .431  | .246 | .433      |
|                                      |             |              |            |      |       |       |      |       |      |           |
| SHEREX Part Number<br>Metric - Steel | Thread Size | Radial Float | Grip Range |      | L     | HD    | HT   | D     | IL   | Hole Size |
|                                      |             |              | Min.       | Max. |       |       |      |       |      |           |
| RFSL2-470-3.3                        | M4x0.7 ISO  | 0.50         | 0.5        | 3.3  | 10.30 | 14.10 | .85  | 10.95 | 6.25 | 11.00     |
| RFSL2-580-3.3                        | M5x0.8 ISO  | 0.50         | 0.5        | 3.3  | 10.30 | 14.10 | .85  | 10.95 | 6.25 | 11.00     |

Prints and Technical Data are available at [www.sherex.com](http://www.sherex.com)  
Patent Pending